

Terminal Units - Bypass

Model: PSMB - Pressure Dependent - Pneumatic Actuator

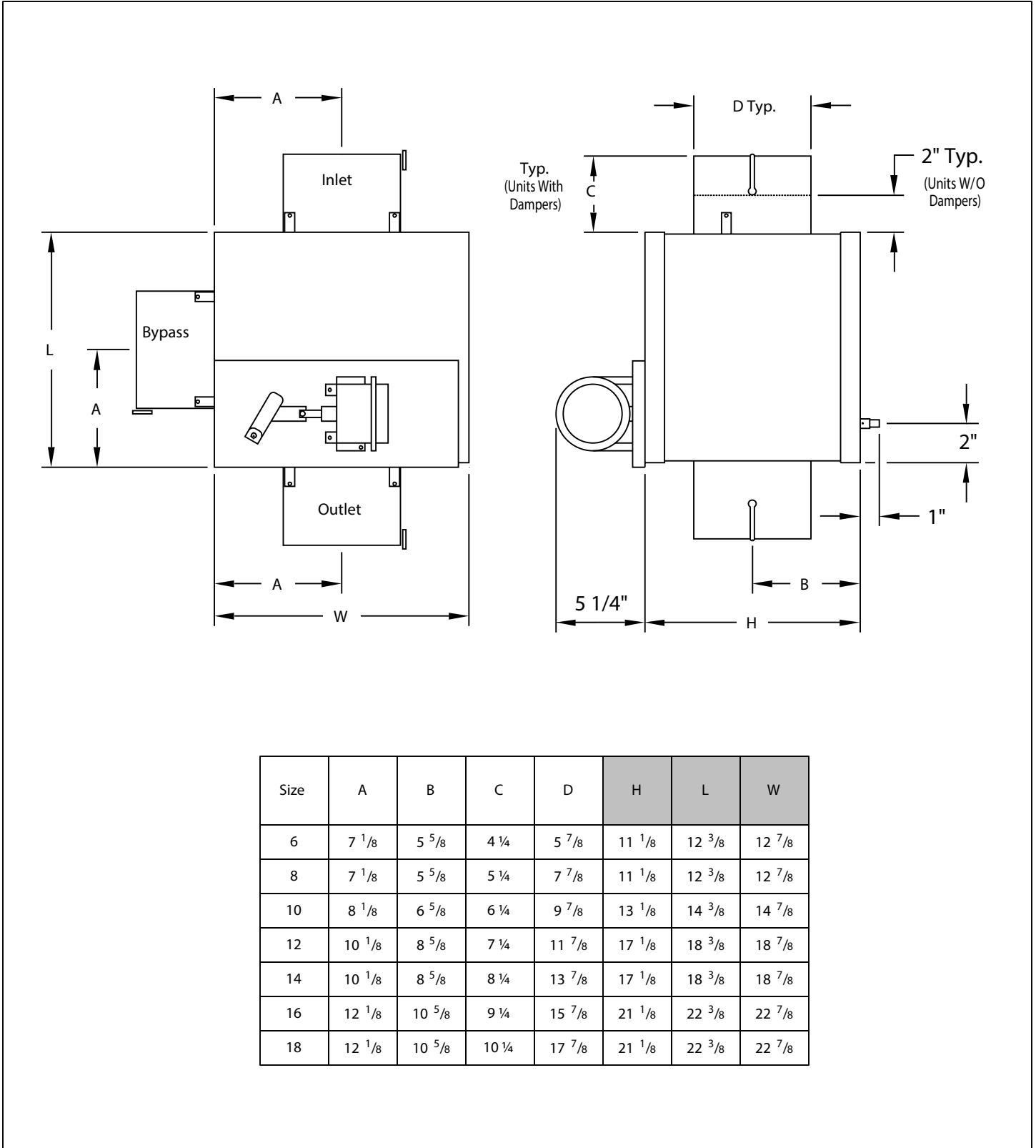

Size	A	B	C	D	H	L	W
6	7 1/8	5 5/8	4 1/4	5 7/8	11 1/8	12 3/8	12 7/8
8	7 1/8	5 5/8	5 1/4	7 7/8	11 1/8	12 3/8	12 7/8
10	8 1/8	6 5/8	6 1/4	9 7/8	13 1/8	14 3/8	14 7/8
12	10 1/8	8 5/8	7 1/4	11 7/8	17 1/8	18 3/8	18 7/8
14	10 1/8	8 5/8	8 1/4	13 7/8	17 1/8	18 3/8	18 7/8
16	12 1/8	10 5/8	9 1/4	15 7/8	21 1/8	22 3/8	22 7/8
18	12 1/8	10 5/8	10 1/4	17 7/8	21 1/8	22 3/8	22 7/8

(Please see reverse side)

Standard Control Applications

COOLING		HEATING	
Direct Acting Thermostat	Reverse Acting Thermostat	Direct Acting Thermostat	Reverse Acting Thermostat
Diverter Plate Closed to Outlet	Diverter Plate Closed to Bypass	Diverter Plate Closed to Outlet	Diverter Plate Closed to Bypass

• Air consumption based on type thermostat used only. No air consumption for terminal unit

Accessories (Optional)

Check if provided.

- | | | |
|--|--|--|
| <input type="checkbox"/> Locking Damper on the inlet | <input type="checkbox"/> Locking Damper on the Bypass outlet | <input type="checkbox"/> Locking Damper on the Inlet, outlet and Bypass outlet |
| <input type="checkbox"/> Locking Damper on the inlet and bypass outlet | <input type="checkbox"/> Hanger brackets | <input type="checkbox"/> _____ |

General Description

- Model PSMB room bypass terminals vary the volume of air supplied to the room by diverting 0 to 100% the air through a bypass opening and into the system return. While the room air supply varies, the supply fan operates at constant volume.
- Durable rubber seal on outlet and bypass opening which the diverter plate closes against.
- The pneumatic actuator is an integral part of the bypass terminal. An actuator spring range of 8 to 13 psi is standard.
- Heavy gauge steel housing.
- Dual density insulation is coated to prevent air erosion. Meets requirements of NFPA 90A, and UL181.
- Diverter plate rides on heavy-duty self lubricating bearings.



Note: This submittal is meant to demonstrate general dimensions of this product. The drawings on this submittal are not meant to detail every aspect of the product with exactness. Drawings are not to scale. TITUS reserves the right to make changes without written notice.

605 Shiloh Road • Plano, Texas 75074 • 972-212-4800