

TFS - Size A

Fan Powered Terminal, Series Flow

Digital (DTFS), Analog (ATFS), Pressure Independent

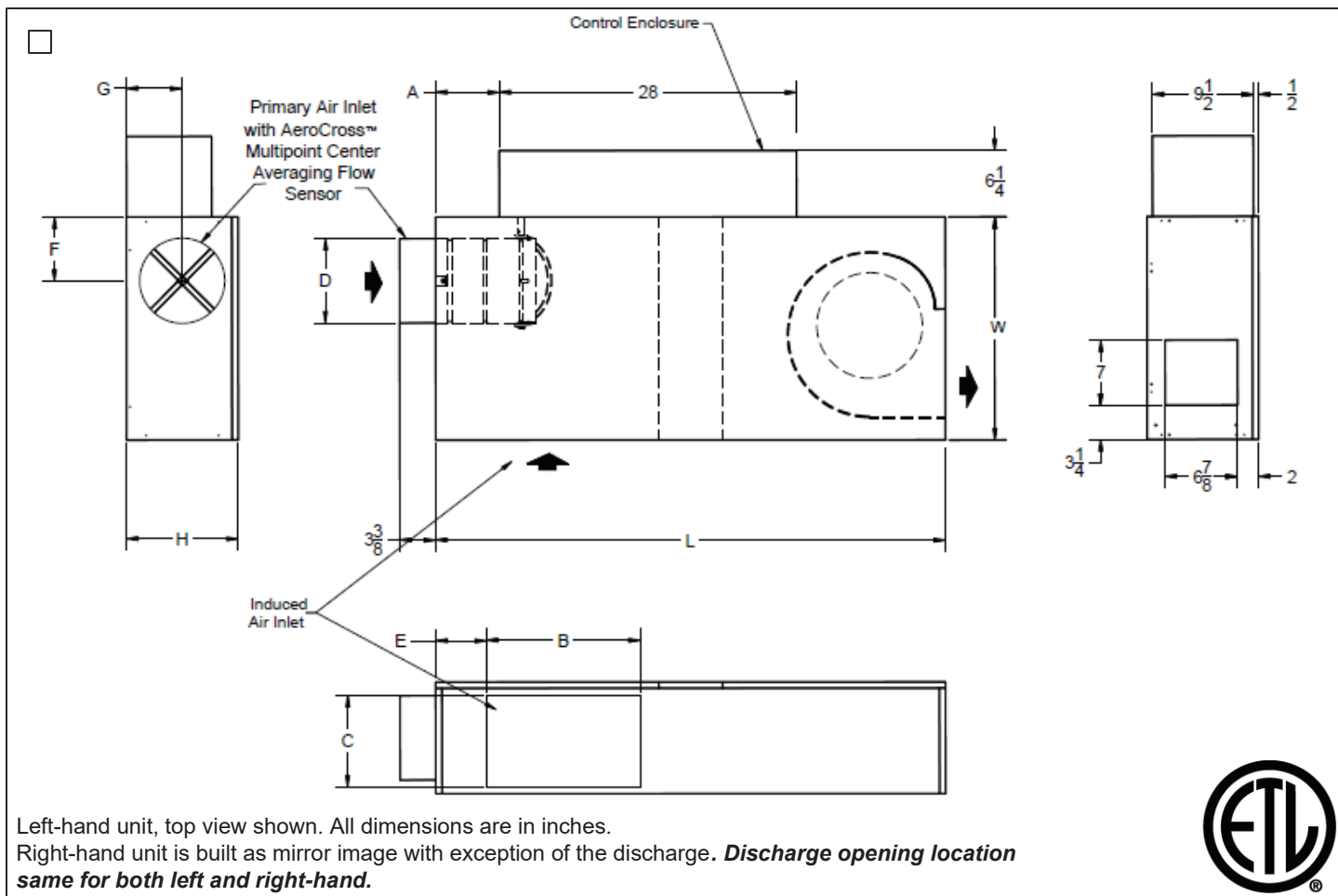

Unit Size	Inlet Size	A	B	C	D	E	F	G	H	L	W	Filter Size
A	6" Diameter	6	14	8	5 ⁷ / ₈	3	5 ⁵ / ₈	5 ¹ / ₄	10 ¹ / ₂	48	21	10 x 16

☐ PSC Motor Amperage Ratings

Unit Size	Motor hp	120/1/60 FLA	208/240/1/60 FLA	277/1/60 FLA
A	¹ / ₁₀	1.6	0.6	0.55

☐ ECM Motor Amperage Ratings

Unit Size	Motor hp	120/1/60 FLA	208/240/1/60 FLA	277/1/60 FLA
A	¹ / ₃	5.0	2.8	2.6

FLA = Full Load Amperage, as tested in accordance with UL 60335

All fan motors are single phase, same voltage as electric coil (when supplied), with exception that 277 V motors are used with 480V, 3 phase coils (4 wire wye).

Accessories (Optional)

Check ☒ if provided.

- ☐ Induced Air Filter, 1" thick, disposable construction type.
- ☐ Toggle disconnect switch (not available on units with optional electric coils.)
- ☐ Fibre Free Liner
- ☐ 1/2" EcoShield Liner
- ☐ 1/2" Fibre Free Liner
- ☐ Foil Face Liner
- ☐ Fan unit fusing
- ☐ Cam Latch for Access Door
- ☐ 1/2" EcoShield Liner (Foil Face)
- ☐ Hanger Brackets
- ☐ OSP & IBC Certification

TFS - Size A

Fan Powered Terminal, Series Flow

Pneumatic Control (PTFS), Pressure Independent

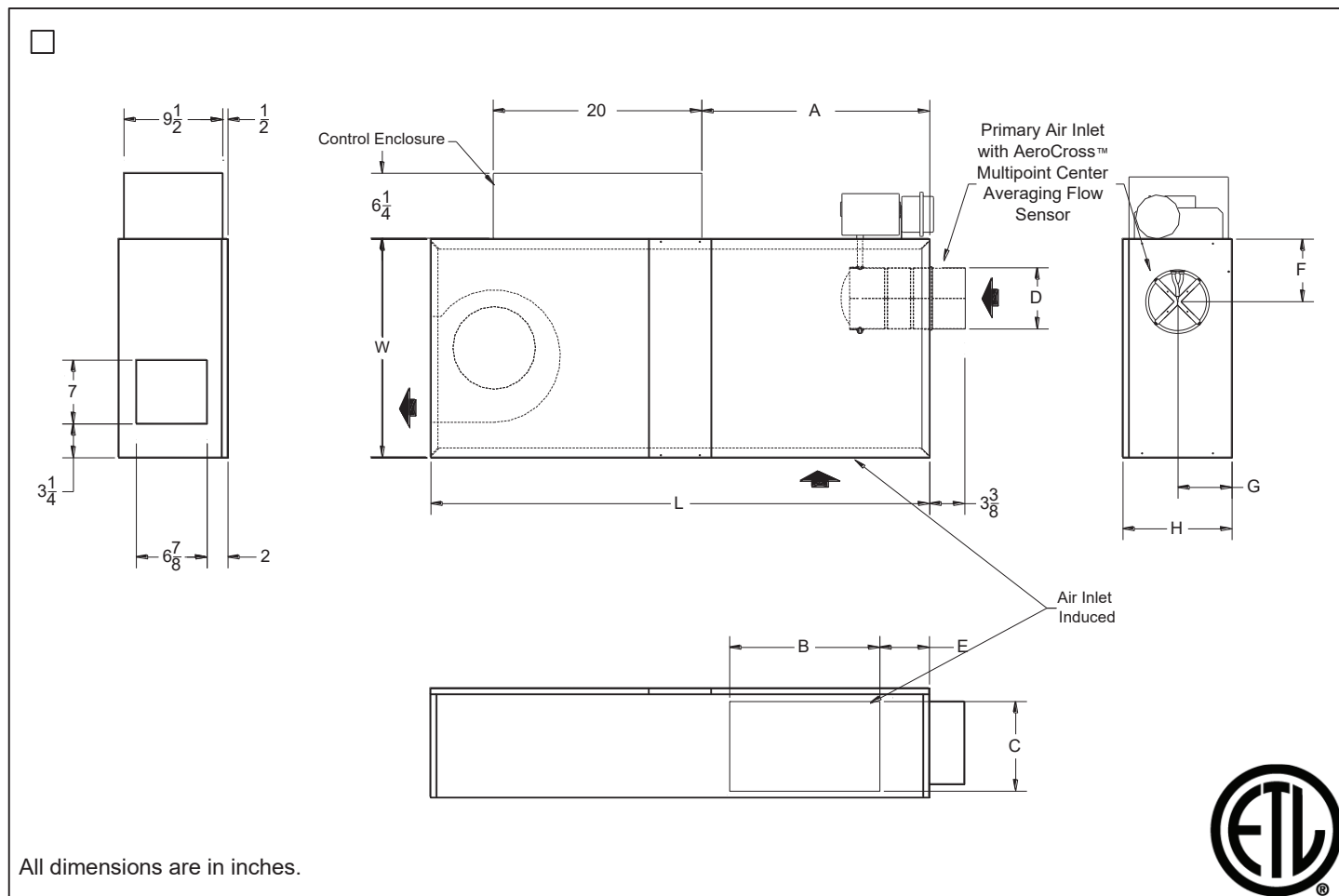

Unit Size	Inlet Size	A	B	C	D	E	F	G	H	L	W	Filter Size
A	6" Diameter	6	14	8	5 7/8	3	5 5/8	5 1/4	10 1/2	48	21	10 x 16

☐ PSC Motor Amperage Ratings

Unit Size	Motor hp	120/1/60 FLA	208/240/1/60 FLA	277/1/60 FLA
A	1 1/10	1.6	0.6	0.55

☐ ECM Motor Amperage Ratings

Unit Size	Motor hp	120/1/60 FLA	208/240/1/60 FLA	277/1/60 FLA
A	1 1/3	5.0	2.8	2.6

FLA = Full Load Amperage, as tested in accordance with UL 60335

All fan motors are single phase, same voltage as electric coil (when supplied), with exception that 277 V motors are used with 480V, 3 phase coils (4 wire wye).

Accessories (Optional)

Check ☒ if provided.

- ☐ Induced Air Filter, 1" thick, disposable construction type.
- ☐ Toggle disconnect switch (not available on units with optional electric coils.)
- ☐ Fibre Free Liner
- ☐ 1/2" EcoShield Liner
- ☐ 1/2" Fibre Free Liner
- ☐ Foil Face Liner
- ☐ Fan unit fusing
- ☐ Cam Latch for Access Door
- ☐ 1/2" EcoShield Liner (Foil Face)
- ☐ Hanger Brackets
- ☐ OSP & IBC Certification

TFS - Sizes B through E

Fan Powered Terminal, Series Flow

Digital (DTFS), Analog (ATFS), Pressure Independent

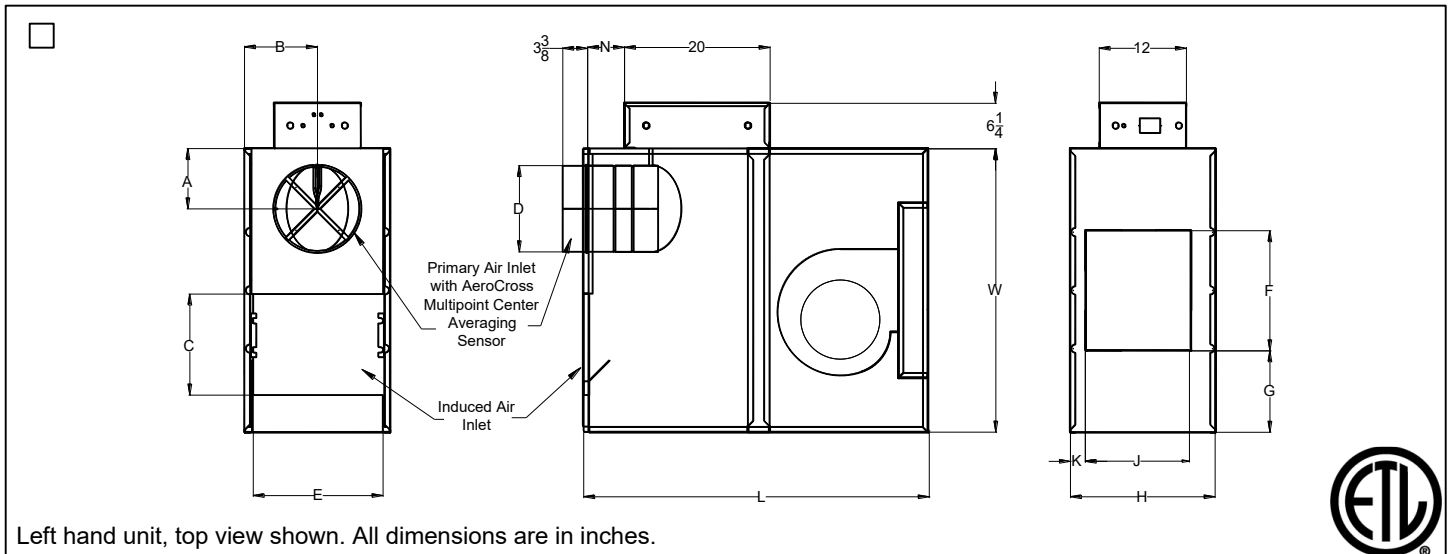

Unit Size	Inlet Size	A	B	C	D	E	F	G	H	J	K	L	N	W	Filter Size
B	6 8 10 12	6 6 7 8	8	12 1/2	5 7/8 7 7/8 9 7/8 11 7/8	14 1/4	14 1/8	11 1/2	16	11 1/8	2 1/4	43	2 7/8 2 7/8 4 7/8 4 7/8	37	16 x 14
C	6 8 10 12	6 6 7 8			5 7/8 7 7/8 9 7/8 11 7/8								2 7/8 2 7/8 4 7/8 4 7/8		
D	10 12 14 16	7 8 10 11			9 7/8 11 7/8 13 7/8 15 7/8								4 7/8 4 7/8 6 7/8 6 7/8		
E	12 14 16	8 10 11			11 7/8 13 7/8 15 7/8								4 7/8 6 7/8 6 7/8		

PSC Motor Amperage Ratings

Unit Size	Motor hp	120V/1/60 FLA	208V/1/60 FLA	277V/1/60 FLA
B	1/6	3.0	1.4	1.0
C	1/4	3.9	1.7	1.5
D	1/3	7.4	3.0	2.6
E	3/4	11.2	5.3	4.5

ECM Motor Amperage Ratings

Unit Size	Motor hp	120/1/60 FLA	208/1/60 FLA	277/1/60 FLA
B	1/3	5.0	2.8	2.6
C	1/3	5.0	2.8	2.6
D	1/2	7.7	4.3	4.1
E	3/4	9.6	6.8	5.5

Accessories (Optional)

Check ☒ if provided.

- ☐ Induced Air Filter, 1" thick, disposable construction type.
- ☐ Fan disconnect switch (not available on units with optional electric coils.)
- ☐ Fibre Free Liner
- ☐ SteriLoc Liner
- ☐ 1/2" EcoShield Liner
- ☐ 1/2" EcoShield Liner (Foil Face)
- ☐ 1/2" Fibre Free Liner
- ☐ Fan unit fusing
- ☐ Cam Latch for Access Door
- ☐ 1" Fiberglass Liner
- ☐ 1" EcoShield Liner
- ☐ 1" EcoShield Liner (Foil Face)
- ☐ 1" Fibre Free Liner
- ☐ Hanger Brackets
- ☐ OSP & IBC Certification
- ☐ IAQ Air Inlet

FLA = Full Load Amperage, as tested in accordance with UL 60335

All fan motors are single phase, same voltage as electric coil (when supplied), with exception that 277V motors are used with 480V, 3 phase coils (4 wire wye).

TFS - Sizes B through E

Fan Powered Terminal, Series Flow

Pneumatic Control (PTFS), Pressure Independent

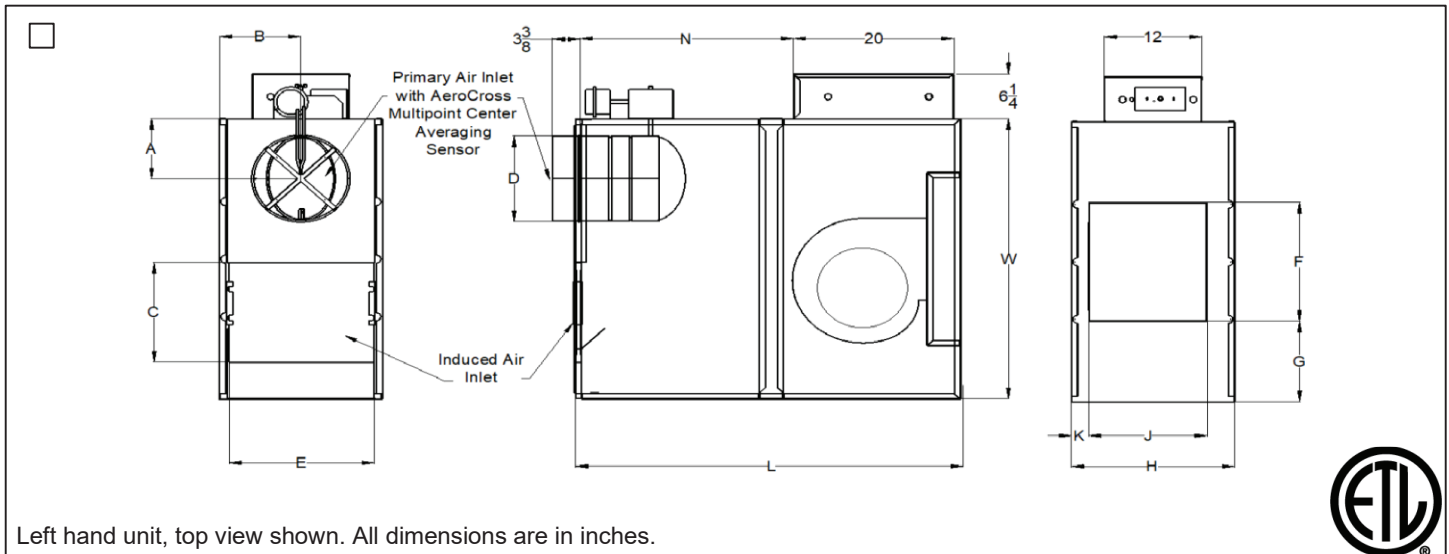

Unit Size	Inlet Size	A	B	C	D	E	F	G	H	J	K	L	N	W	Filter Size
B	6 8 10 12	6 6 7 8	8	12 1/2	5 7/8 7 7/8 9 7/8 11 7/8	14 1/4	14 1/8	11 1/2	16	11 1/8	2 1/4	43	2 7/8 2 7/8 4 7/8 4 7/8	37	16 x 14
C	6 8 10 12	6 6 7 8			5 7/8 7 7/8 9 7/8 11 7/8								2 7/8 2 7/8 4 7/8 4 7/8		
D	10 12 14 16	7 8 10 11			9 7/8 11 7/8 13 7/8 15 7/8								4 7/8 4 7/8 6 7/8 6 7/8		
E	12 14 16	8 10 11			11 7/8 13 7/8 15 7/8								4 7/8 6 7/8 6 7/8		

PSC Motor Amperage Ratings

Unit Size	Motor hp	120/1/60 FLA	208/1/60 FLA	277/1/60 FLA
B	1/6	3.0	1.4	1.0
C	1/4	3.9	1.7	1.5
D	1/3	7.4	3.0	2.6
E	3/4	11.2	5.3	4.5

ECM Motor Amperage Ratings

Unit Size	Motor hp	120/1/60 FLA	208/1/60 FLA	277/1/60 FLA
B	1/3	5.0	2.8	2.6
C	1/3	5.0	2.8	2.6
D	1/2	7.7	4.3	4.1
E	3/4	9.6	6.8	5.5

Accessories (Optional)

Check ☒ if provided.

- ☐ Induced Air Filter, 1" thick, disposable construction type.
- ☐ Fan disconnect switch (not available on units with optional electric coils.)
- ☐ Fibre Free Liner
- ☐ SteriLoc Liner
- ☐ 1/2" EcoShield Liner
- ☐ 1/2" EcoShield Liner (Foil Face)
- ☐ 1/2" Fibre Free Liner
- ☐ Fan unit fusing
- ☐ Cam Latch for Access Door
- ☐ 1" Fiberglass Liner
- ☐ 1" EcoShield Liner
- ☐ 1" EcoShield Liner (Foil Face)
- ☐ 1" Fibre Free Liner
- ☐ Hanger Brackets
- ☐ OSP & IBC Certification
- ☐ IAQ Air Inlet

FLA = Full Load Amperage, as tested in accordance with UL 60335

All fan motors are single phase, same voltage as electric coil (when supplied), with exception that 277V motors are used with 480V, 3 phase coils (4 wire wye).

TFS - Size G

Fan Powered Terminal, Series Flow
Digital (DTFS), Analog (ATFS), Pressure Independent

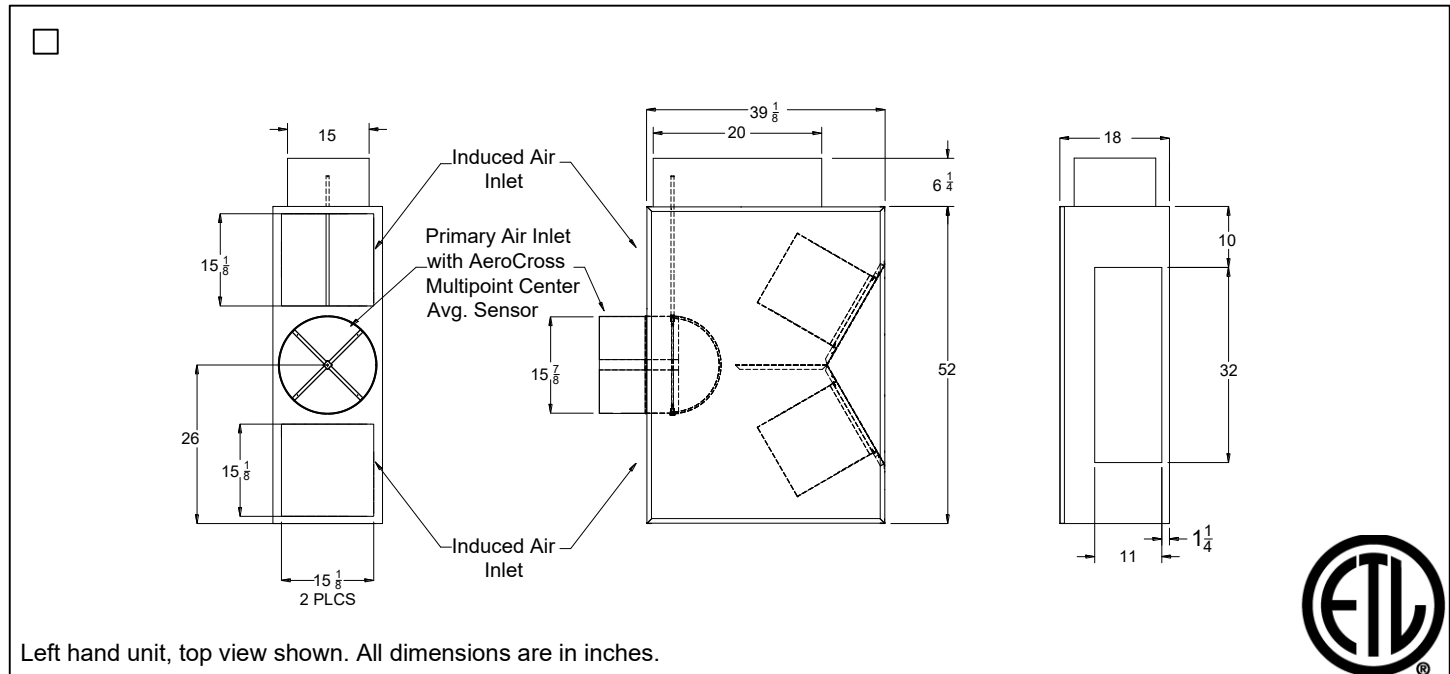

Unit Size	Inlet Size	Filter Size
G	16	17 x 17

☐ PSC Motor Amperage Ratings

Unit Size	Motor hp	208/1/60 FLA	277/1/60 FLA
G	(2) 3/4	10.2	8.4

☐ ECM Motor Amperage Ratings

Unit Size	Motor hp	120/1/60 FLA	208/1/60 FLA	277/1/60 FLA
G	(2) 1	25.6	18.2	13.8

Accessories (Optional)

Check ☒ if provided.

- ☐ Induced Air Filter, 1" thick, disposable construction type.
- ☐ Fan disconnect switch (not available on units with optional electric coils.)
- ☐ Fibre Free Liner
- ☐ SteriLoc Liner
- ☐ 1/2" EcoShield Liner
- ☐ 1/2" EcoShield Liner (Foil Face)
- ☐ 1/2" Fibre Free Liner
- ☐ Fan unit fusing
- ☐ Cam Latch for Access Door
- ☐ 1" Fiberglass Liner
- ☐ 1" EcoShield Liner
- ☐ 1" EcoShield Liner (Foil Face)
- ☐ 1" Fibre Free Liner
- ☐ Hanger Brackets
- ☐ OSP & IBC Certification
- ☐ IAQ Air Inlet

FLA = Full Load Amperage, as tested in accordance with UL 60335

All fan motors are single phase, same voltage as electric coil (when supplied), with exception that 277V motors are used with 480V, 3 phase coils (4 wire wye).

TFS - Size G

Fan Powered Terminal, Series Flow

Pneumatic Control (PTFS), Pressure Independent

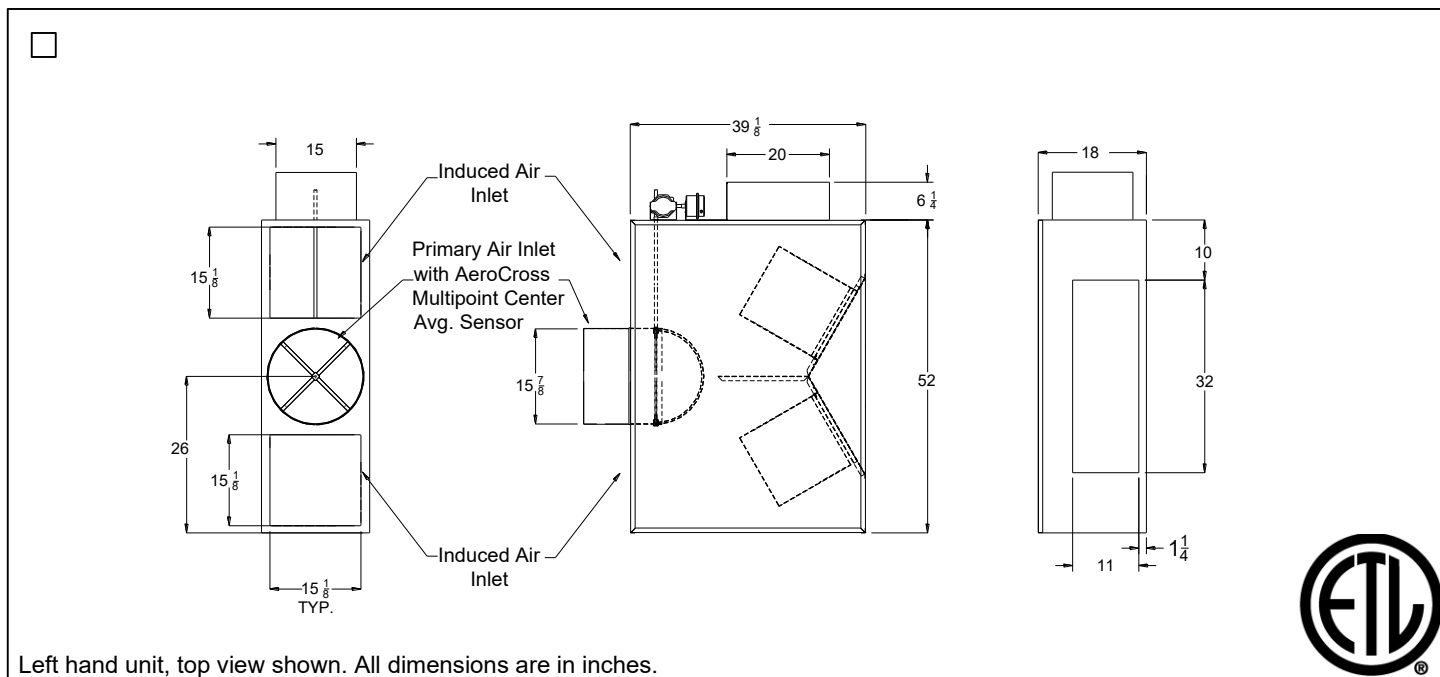

Unit Size	Inlet Size	Filter Size
G	16	17 x 17

☐ PSC Motor Amperage Ratings

Unit Size	Motor hp	208/240/1/60 FLA	277/1/60 FLA
G	(2) 3/4	10.2	8.4

☐ ECM Motor Amperage Ratings

Unit Size	Motor hp	120/1/60 FLA	208/240/1/60 FLA	277/1/60 FLA
G	(2) 1	25.6	18.2	13.8

Accessories (Optional)

Check ☒ if provided.

- ☐ Induced Air Filter, 1" thick, disposable construction type.
- ☐ Fan disconnect switch (not available on units with optional electric coils.)
- ☐ Fibre Free Liner
- ☐ SteriLoc Liner
- ☐ 1/2" EcoShield Liner
- ☐ 1/2" EcoShield Liner (Foil Face)
- ☐ 1/2" Fibre Free Liner
- ☐ Fan unit fusing
- ☐ Cam Latch for Access Door
- ☐ 1" Fiberglass Liner
- ☐ 1" EcoShield Liner
- ☐ 1" EcoShield Liner (Foil Face)
- ☐ 1" Fibre Free Liner
- ☐ Hanger Brackets
- ☐ OSP & IBC Certification

FLA = Full Load Amperage, as tested in accordance with UL 60335

All fan motors are single phase, same voltage as electric coil (when supplied), with exception that 277V motors are used with 480V, 3 phase coils (4 wire wye).

Accessories (Optional)

- ☐ Hot Water Coil Section
- 1/2" copper tubes
 - Aluminum ripple fins, 10 per inch
 - Size A Connections : Male solder OD, 1/2" for both 1-row and 2-row.
 - Size B through G Connections : Male solder, 5/8" for both 1-row and 2-row.
 - Left hand or right hand connections
 - Galvanized steel casing
 - Flanged duct connection.
 - Coil is installed on discharge of unit.

☐ 1 Row

☐ 2 Row

TFS - Size A

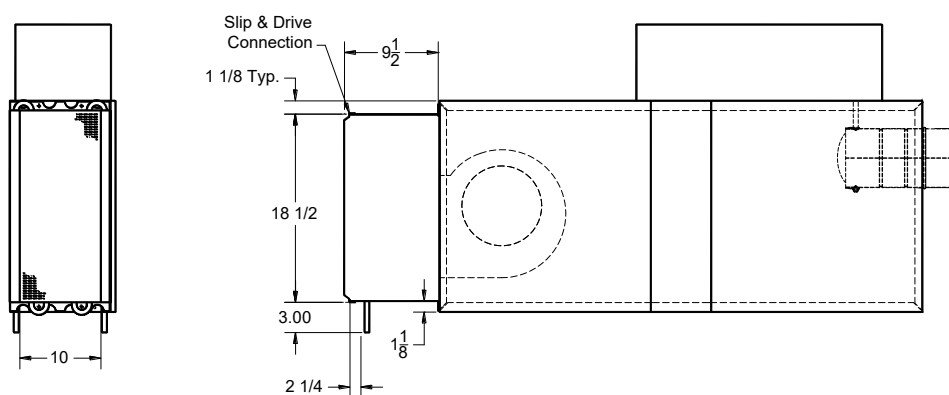

TFS - Size B Through G

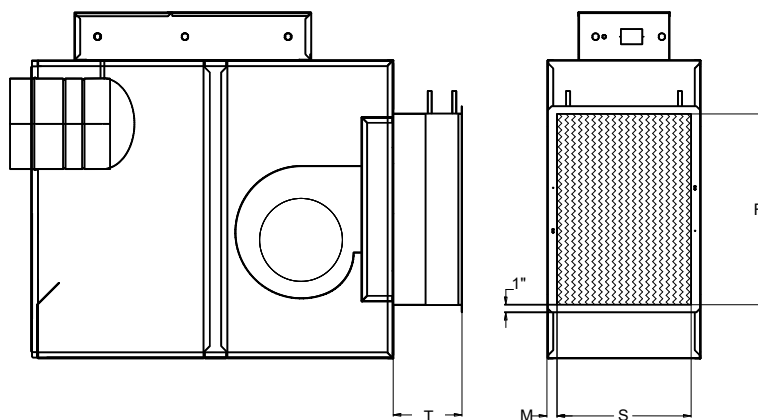

Unit Size	M (1 row)	M (2 row)	R	S	T
B, C	1	1	20 1/2	12 1/2	9
D, E	1	1 1/4	25	17 1/2	9
G	2	2	34	15	12

R and S are inside dimensions.
 Sizes B through E shown

Accessories (Optional)

- ☐ Electric Coil Section ☐ Optional Lynergy Controlled SCR Electric Heater

Standard Features

- Single side access to low voltage, high voltage, and electric heater controls.
- Automatic reset thermal cutouts, one per element
- Single point electrical connection for entire unit
- Positive pressure flow switch
- Flanged duct connection
- Coil is installed at discharge of unit.
- Transformer

TFS - Size A

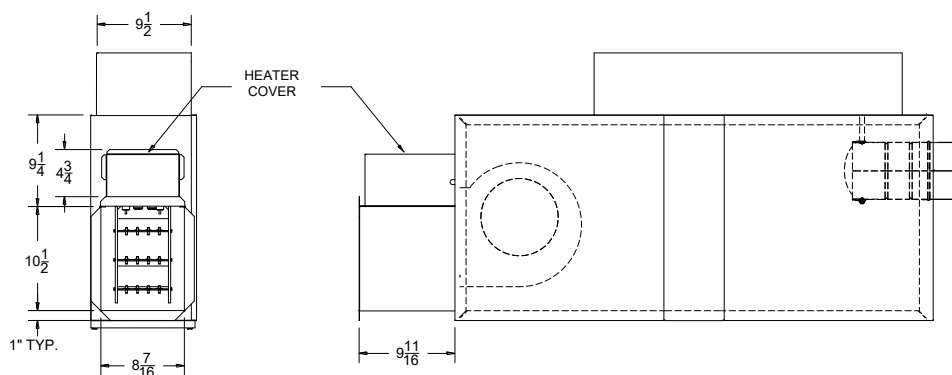

TFS - Size B Through G

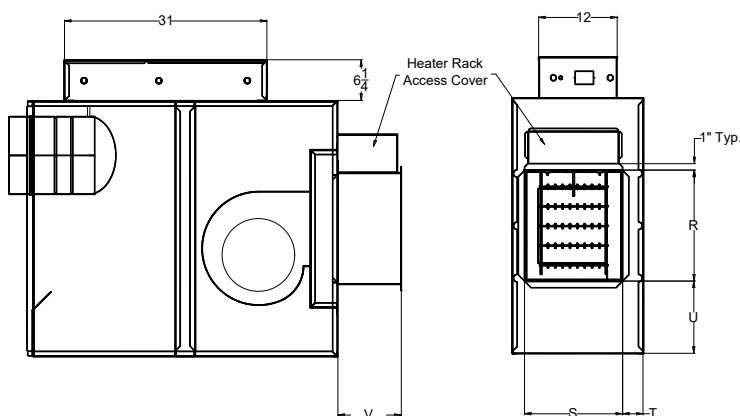

Unit Size	U	R	S	T	V
B, C	11 ³ / ₈	14 ¹ / ₂	11 ¹ / ₂	3 ³ / ₈	9 ³ / ₄
D, E	11	17	15	3 ³ / ₈	9 ³ / ₄
G	9	34	15	2	12

R and S are inside dimensions.
Sizes B through E shown

Options

- ☐ Fuse Block
☐ Disconnect switch, door interlock type
☐ Manual reset cutout
☐ Dust tight construction
☐ Mercury contactors

Supply Voltage

- ☐ 208V, 1 ph, 60Hz
☐ 240V, 1 ph, 60Hz
☐ 277V, 1 ph, 60Hz
☐ 208V, 3 ph, 60Hz
☐ 480V, 3 ph, 60Hz (4 wire wye only)

Accessories (Optional)

Hanger Bracket Location

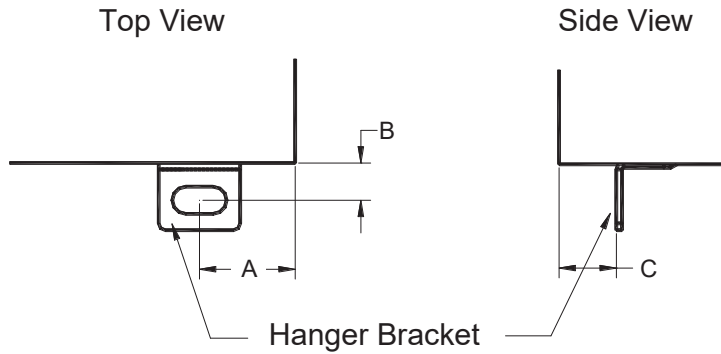

Unit Size	A	B	C
A	1 5/8	5/8	3/4
B, C	1 3/4	5/8	1
D, E	1 3/4	5/8	1
G	1 1/2	1/2	1/8

TFS - IAQ Inlet

- Allows outside air into terminal unit to improve indoor air quality
- Available on Unit Sizes B, C, D, and E
- For use with ECM motors only

TFS Series Unit with IAQ Inlet																			
Unit Size	Primary	IAQ	A	B	C	D	D2	E	F	G	H	J	K	L	N	W	P	R	Filter Size
	Inlet Size																		
B	6	4	6	8	9 9/10	5 7/8	3 7/8	14 1/4	14 1/8	11 1/2	16	11 1/8	2 1/4	43	2 7/8	37	10 1/5	4 5/7	12 X 14
	8		6			7 7/8									4 7/8				
	10		7			9 7/8									5 7/8				
	12		8			11 7/8									4 7/8				
C	6	6	6			5 7/8									2 7/8				
	8		6			7 7/8									2 7/8				
	10		7			9 7/8									4 7/8				
	12		8			11 7/8									4 7/8				
D	10	7	7	10	9 7/8	9 7/8	6 7/8	18 1/4	16 1/2	11 1/4	20	14 5/8	2	47 1/2	4 7/8	39	10 1/5	4 5/7	12 X 18
	12		8			11 7/8									4 7/8				
	14		10			13 7/8									6 7/8				
	16		11			15 7/8									6 7/8				
E	12	8	8			11 7/8									4 7/8				
	14		10			13 7/8									6 7/8				
			11			15 7/8									6 7/8				
	16																		

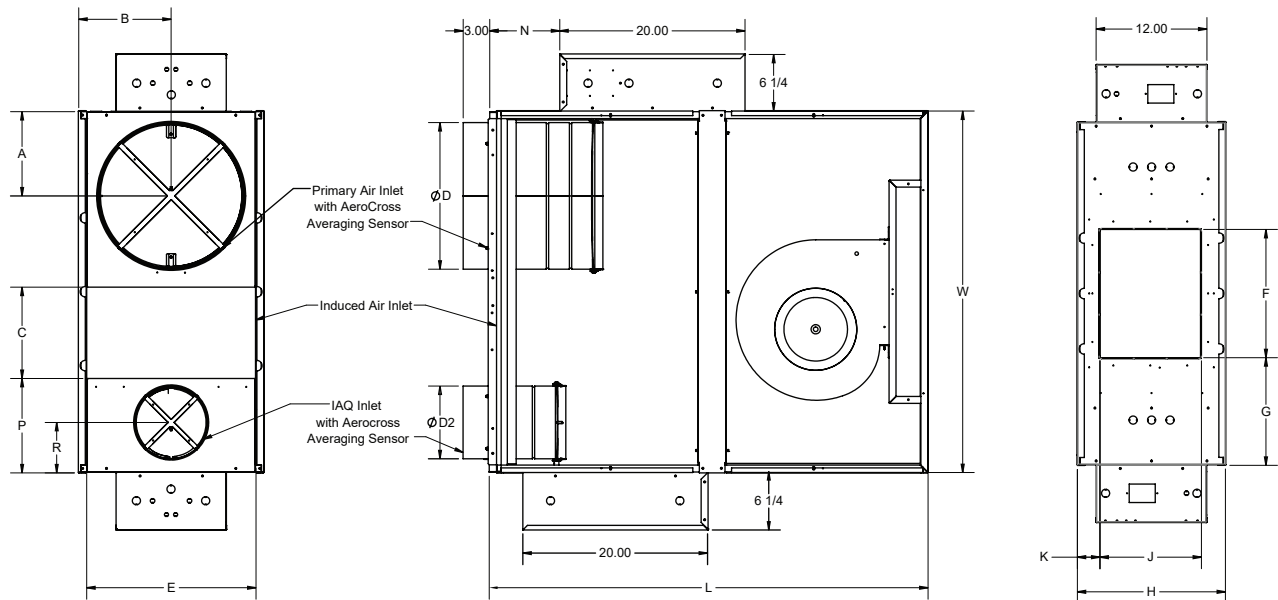

General Description

- Heavy steel casing
- Dual density insulation, coated to prevent air erosion, meet requirements of NFPA 90A and UL 181.
- Motor mounted in vibration isolators
- PSC Only: Adjustable SCR fan speed control with minimum voltage stop.
- Size A : Bottom access panels can be removed for service
- Size B through G : Top and bottom access panels can be removed for service.
- Multipoint, center averaging velocity sensor.
- Primary air flow balancing connections.
- Pressure independent primary flow control.
- Single point electrical connections.
- Rectangular discharge opening is designed for flanged duct connections.
- OSHPD Seismic Certification: OSP-0352-10
- Only Titus Alpha digital controls package and Titus pneumatic approved for seismic installation.

ECM Only

- Minimum efficiencies of 70% across the entire operating range
- Provides a large turndown ratio
- Manual PWN controller allows simple screwdriver adjustment of fan speed
- Optional remote PWM controller allows for a 0-10 V signal from the DDC controller to adjust the fan speed